

Connecting AVerVision SPC Series with a Microscope

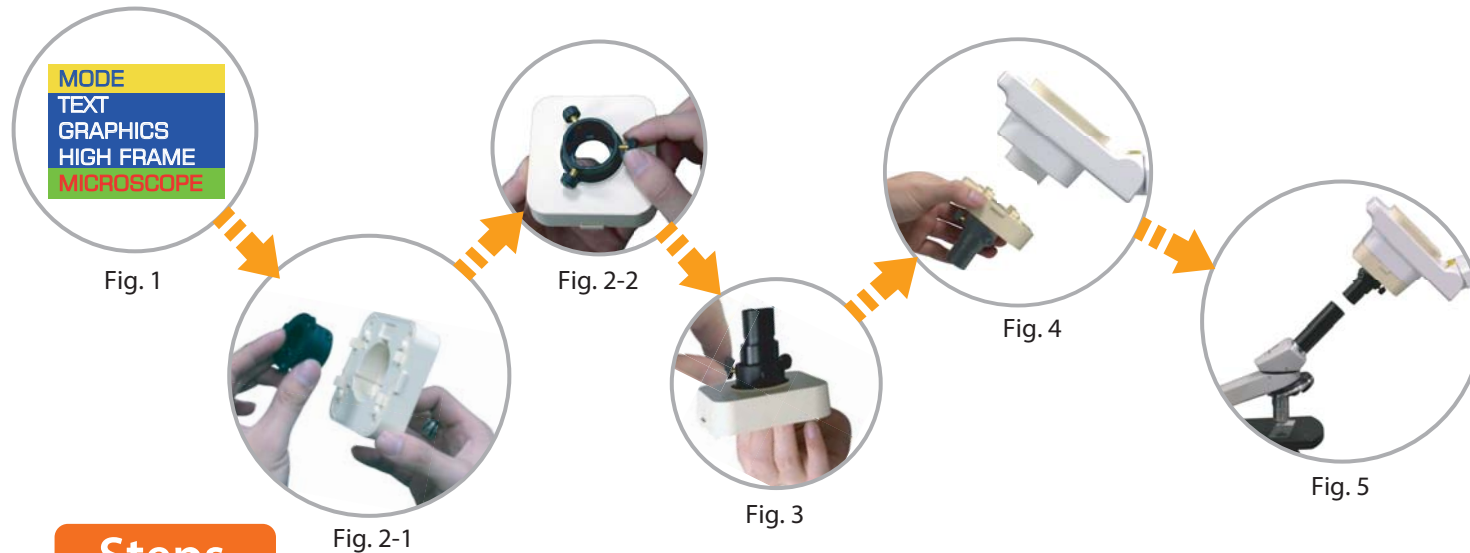

Steps

1. Connect projector/monitor (VGA/RGB in port) and Visualizer (VGA out port) with a VGA cable
2. Press Menu to show OSD. Go to Mode and change it to Microscope (Fig. 1)
3. Aim the camera head at a far distance (e.g. wall/ceiling) and then press Auto Focus to get a clear image
4. Put together the 2 microscope adapter pieces and lightly screw in the 3 bolts (Fig. 2-1, 2-2)
5. Secure the microscope eyepiece at the center of the microscope adapter by tightening the bolts (Fig. 3)
6. Connect the microscope adapter with the eyepiece to the camera head (Fig. 4)
7. Insert the eyepiece back into the microscope (Fig. 5)
8. Adjust the camera head and microscope so that they are linearly connected. If they are correctly connected, the image should be big and clear

NOTE:

1. For HD quality images, you may want to connect the Visualizer (DVI-I out port) and monitor with a DVI cable or a DVI cable with HDMI mounting adapter



We suggest using a microscope with an eye relief of 15.5mm or higher for better view.